



sanborn

www.sanborn.com
1.866.726.2676

CitySets®

Downtown Digital Data

The Sanborn CitySets product line is a series of off-the-shelf digital data sets covering the core downtown areas of major cities across the United States.

Sanborn CitySets provides valuable GIS data for:

Emergency operations centers, Department of Homeland Security, Department of Defense, Architectural and engineering firms, Real estate developers, Urban planning and transportation departments, Security planning and training organizations, Public and private utility providers.

Digital Orthophoto Imagery

- 6-inch or 1-foot pixel resolution, color imagery
- Meets National Map Accuracy Standards (90 percent within 3.33 or 6.66 feet of true position, depending on city)
- Seamless and color balanced
- Available in local State Plane coordinate system
- Orthomosaic deliverable in MrSid® format
- Imagery collected 2002 or later

Geographic Information

- Building-specific data:
 - Accurate building footprints
 - Primary / alternate building addresses
 - Building name(s), construction class, occupancy type, number of stories, year built, building height, square footage, and more
- Street centerlines with street names
- Select geographic features and landmarks (depending on city)
- Meets NMA Standards (90% within 3.33 or 6.66 feet of true position, depending on city)

Sanborn Fire Insurance Maps®

- Digital Sanborn Map® information
- Accurate, seamless, full resolution, deliverable in georeferenced MrSid® format

3D Building Models

- Highly accurate 3D building models
- Deliverable in ESRI z-shape file
- Files can be converted by users to support:
 - AutoCAD
 - Google KML
 - Openflight
 - 3D Studio File Format
- Bald earth terrain surface model included (format: ESRI TIN or GRID)

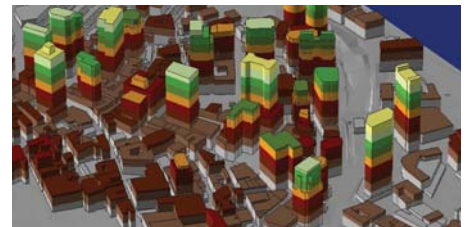



CitySets® data is currently available for the following U.S. cities:

City	2D & 3D Building (Sq. Mi.)	6-Inch Orthoimagery (Sq. Mi.)	1-Foot Orthoimagery (Sq. Mi.)	City	2D & 3D Building (Sq. Mi.)	6-Inch Orthoimagery (Sq. Mi.)	1-Foot Orthoimagery (Sq. Mi.)
Arlington/pentagon City	4.6	4.6	4.6	Manhattan	10.2	10.2	100.0
Atlanta	3.3	3.3	3.3	Memphis	3.8	-	50.0
Baltimore	2.4	2.4	50.0	Miami	4.0	4.0	100.0
Boston	3.0	3.0	100.0	Minneapolis	2.0	2.0	2.0
Brooklyn	2.0	2.0	100.0	Newark	3.4	-	100.0
Buffalo	3.5	-	50.0	New Orleans	3.2	3.2	50.0
Chicago	15	15	140.0	Philadelphia	5.3	5.3	100.0
Cincinnati	3.8	-	50.0	Phoenix	4.2	-	100.0
Cleveland	3.8	-	50.0	Pittsburgh	3.7	-	50.0
Dallas	3.8	3.8	50.0	Portland	1.4	1.4	50.0
Denver	2.0	2.1	100.0	Sacramento	3.1	-	65.0
Detroit	2.8	2.8	100.0	San Diego	2.1	2.1	100.0
Ft. Lauderdale	3.6	3.6	3.6	San Francisco	5.8	5.8	100.0
Honolulu	3.8	-	50.0	Seattle	3.6	3.6	125.0
Houston	3.4	3.4	100.0	St. Louis	4.8	4.8	50.0
Jersey City	3.5	3.5	3.5	St. Paul	1.2	1.2	4.8
Kansas City	3.8	-	50.0	St. Petersburg	2.6	2.6	2.6
Las Vegas	6.3	6.3	6.3	Tampa	0.9	0.9	50.0
Long Beach	3.2	-	50.0	Washington, D.C.	7.4	7.4	130.0
Los Angeles	10.2	10.2	100.0				

Conditions

- Pricing catalog is subject to change.
- Product is warranted for 90 days as defined in the End User License Agreement
- Most orders can be shipped within 48 hours from date of purchase (depending on the size of the order)
- Shipping and handling fees may apply.

How to order

To order Sanborn CitySets® products or for information about cities not listed, cities to be updated, or for specific Sanborn CitySets® details and pricing, contact Sanborn customer service at 866.SANBORN or email information@sanborn.com.

About Sanborn

Sanborn is a 21st century industry leader in geospatial solutions and technology, offering superior services, program management, and customer support. For our clients we provide a national presence, extensive resources, quick responses, and exceptional value. For over a century, we have been a leader in the rapidly growing geospatial industry, with successful projects delivered worldwide. For more information, visit us online at www.sanborn.com, or call **1.866.726.2676** to speak with a representative.